

AUGER-MATE®

Owners Manual



Set-Up

CAUTION! The Auger-Mate® must be primed before starting. Follow the instructions below to prevent “dry” starting, which can damage the pump.

After the Auger-Mate® unit is securely mounted in place...

1. Fill the engine crankcase with the appropriate engine oil (*Refer to the Engine Service Manual for manufacturer’s recommendations*).
2. Using a good quality, clean hydraulic oil, fill the hydraulic oil reservoir. Reservoir capacity is approximately five (5) gallons. Oil level should be about one and a half inches from the top of the filler neck.
3. If the fuel tank contains fuel, turn the fuel shut-off valve on the engine to the “Off” position and disconnect the spark plug wire.

4. Remove the plastic plugs from the hydraulic control valve and push the handle all the way down.

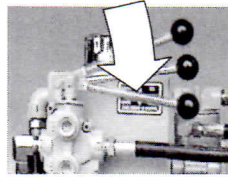

5. Place an appropriate oil catch container under the open valve ports...some oil will be discharged. Stand clear of the open ports while priming.
6. Pull starter rope on engine slowly several times until oil begins to run out of the open port on the control valve.
7. Wipe up spilled oil, return valve handle to the center “neutral” position.

8. Connect the auger hoses to the open ports on the control valve.

DO NOT use water pipe, black iron or galvanized fittings. Use only high pressure fittings and hydraulic hose rated at 2000 psi minimum.

9. Reconnect the spark plug wire, turn on the fuel valve and fill the fuel tank with fuel.

Refer to Engine Service Manual for Manufacturer’s Recommendations on Engine Service and Maintenance.

Start-up

1. Before starting engine, double-check all fittings, connectors and mounting hardware

Valve handle *must* be in the “Neutral” position when starting the engine.

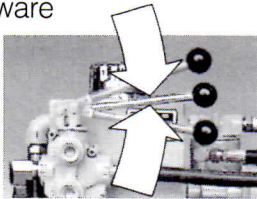

CAUTION! Run the Auger-Mate ONLY in a well-ventilated area, or outdoors.

2. Start the engine. If any leaks are found, shut down the engine *immediately* and correct the leak.
3. With engine running, operate the valve handle to run the auger. If the auger rotation does not match the label near the handle, shut off the engine and reverse the auger hoses at the control valve.

4. If desired, the engine throttle speed may be adjusted if vibration is a problem.
5. Shut off engine after a few minutes of operation to re-check oil level in the hydraulic reservoir and to double-check all fittings and fasteners.

Operation

The standard Auger-Mate is designed to power 6” diameter augers (*up to 14’ in length*) from most manufacturers.

1. Run the Auger-Mate only in a well-ventilated area, or outdoors.
2. Change the hydraulic oil filter at least once per year (*more often under severe conditions or if performance diminishes*).

3. When used with fertilizer, run auger in reverse at the end of each day to prevent moisture packing in the tube. **KEEP IT CLEAN!**
4. Do not allow fertilizer or chemicals to accumulate on the unit.
5. Use only clean, good quality hydraulic oil. *Dirt is the biggest enemy of any hydraulic system!*

CAUTION!

The Auger-Mate in standard form is **NOT** suitable for powering a hydraulic cylinder, or woodsplitter. For safety reasons, these applications require a different valve. Contact **Buckeye Hydraulics** for assistance with these circuits. Special valve kits, speed controls and load holding checks may be necessary.

Auger-Mate® Hydraulic Systems



Since 1971, the Auger-Mate® has been successfully used to drive hydraulic motors on farm auger wagons.

The Auger-Mate is not suitable for every application. If the circuit has a hydraulic motor with a flywheel effect, special considerations must be made to prevent damage to the system.

For any non-standard application, please consult **Buckeye Hydraulics** for assistance.

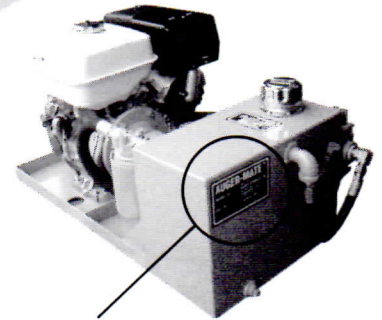
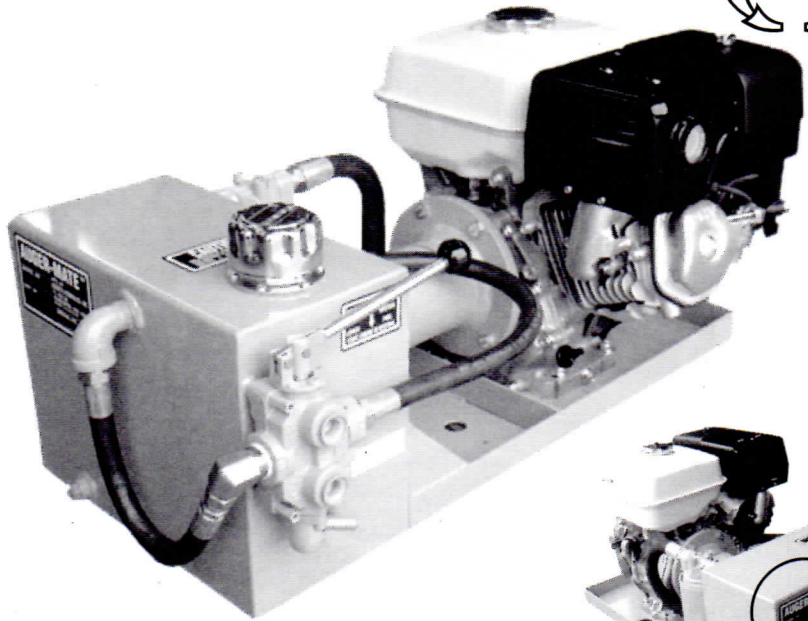

Location of Model Number And Serial Number

When calling to Order Parts or get Technical Assistance:

- Always have BOTH the Model Number and Serial Number of your Auger-Mate available.
- For Parts Orders, have the description and part number of the item(s) that you need.
- For Service Questions, please have the symptoms of the unit plus information about the circuit and application.

Thank you for helping us to help you!

Installation

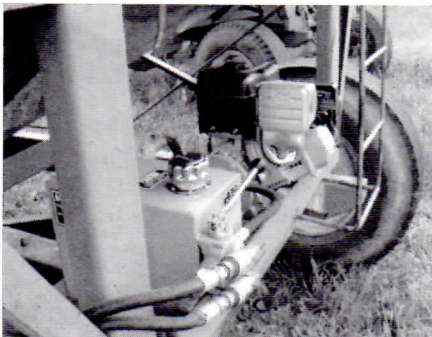

- Remove the Auger-Mate unit from the shipping carton and inspect for shipping damage.
- Mount the unit securely in place.
- The Auger-Mate is typically mounted on a gravity wagon, pickup bed or directly on a grain drill.

Approximate Dry Weight:

130 pounds*

Approximate outside dimensions:

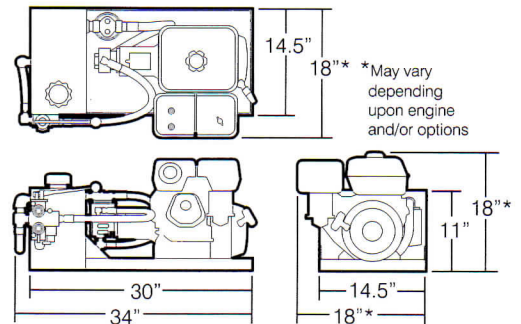

Components and Controls



419-832-2822
1-800-824-1739
 Fax 419-832-0255
 www.buckeyehydraulics.com

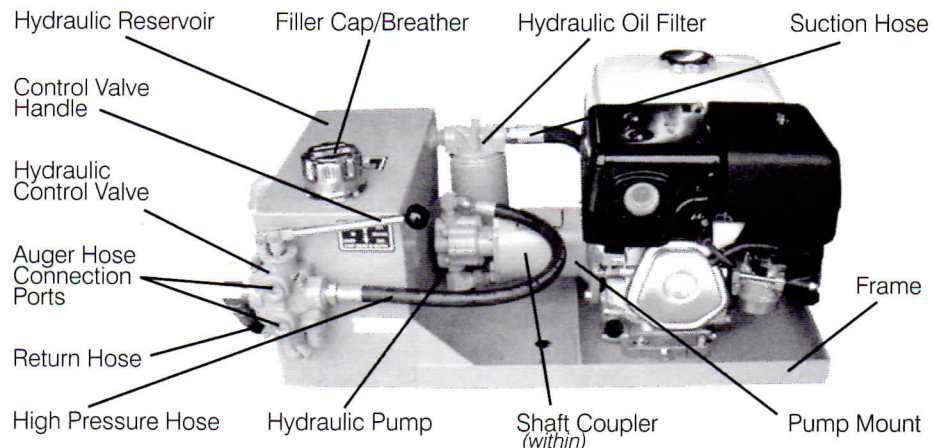

Service and Maintenance

Recommended Oil

Most farm tractor type hydraulic oils are acceptable for the hydraulic reservoir of the Auger-Mate®. Always use clean oil when adding oil to the hydraulic system.

Use of motor oil (10W-30, etc.) may be acceptable.

DO NOT use Automatic Transmission Fluid (ATF) in the Auger-Mate.

DO NOT mix different types of oil when "topping off". Make sure that you are adding the same type of oil that is already in the tank.

Hydraulic System Service Schedule

Daily (every 5 hours of use):

- Check oil level
- Clean off fertilizer, chemicals or debris
- Inspect for oil leaks and repair as appropriate
- Check all hoses, fittings, bolts and hardware to make sure that they are secure and properly tightened
- Empty out auger tube at the end of each day.

Once per season

(20-25 hours of use):

- Change hydraulic oil filter element.

Every two to three years

(75-80 hours of use):

- Drain oil reservoir and refill with clean, good quality hydraulic fluid.

Troubleshooting

Complaint	Cause	Correction
Pump squeals	<ul style="list-style-type: none"> • Oil level low • Oil is cold • Oil tank filler cap/breather plugged • Suction hose bent, collapsed or restricted • Oil filter element plugged/dirty 	<ul style="list-style-type: none"> • Fill to within 1½" of top of filler neck • Run engine at reduced speed for 5-10 minutes • Clean filler cap/breather, replace • Clear obstruction • Replace with new oil filter element
Poor performance		
Low power	<ul style="list-style-type: none"> • Pressure relief in control valve adjusted incorrectly • Pressure relief in control valve sticking or contaminated with dirt • Oil level low • Oil filter plugged/ dirty 	<ul style="list-style-type: none"> • Readjust using pressure gauge • Remove, clean, replace and readjust using pressure gauge • Fill to within 1½" of top of filler neck • Replace with new oil filter element
Low speed	<ul style="list-style-type: none"> • Oil tank filler cap/breather dirty or plugged 	<ul style="list-style-type: none"> • Clean filler cap/breather, replace
Oil bubbling out filler cap	<ul style="list-style-type: none"> • Loose fitting on suction hose, or on filter housing • Filter element loose or plugged 	<ul style="list-style-type: none"> • Tighten as appropriate • Tighten, or replace, as needed

Replacement Parts

Hydraulic Control Valve and Hoses

Part No.	Description
JJ28400	90° Elbow (<i>Reservoir Tank</i>)
ZZ29960	Return Hose
AW21100	90° Elbow (<i>Control Valve</i>)
BD30710	Hydraulic Control Valve (483 Series) Includes Handle
BD30720	Hydraulic Control Valve (588 Series) Includes Handle
BE54200	Control Valve Handle Assembly
ZZ29965	High Pressure Hose

When calling to Order Parts or get Technical Assistance:

- Always have BOTH the Model Number and Serial Number of your Auger-Mate available.
- For Parts Orders, have the description and part number of the item(s) that you need.
- For Service Questions, please have the symptoms of the unit plus information about the circuit and application.

Thank you for helping us to help you!

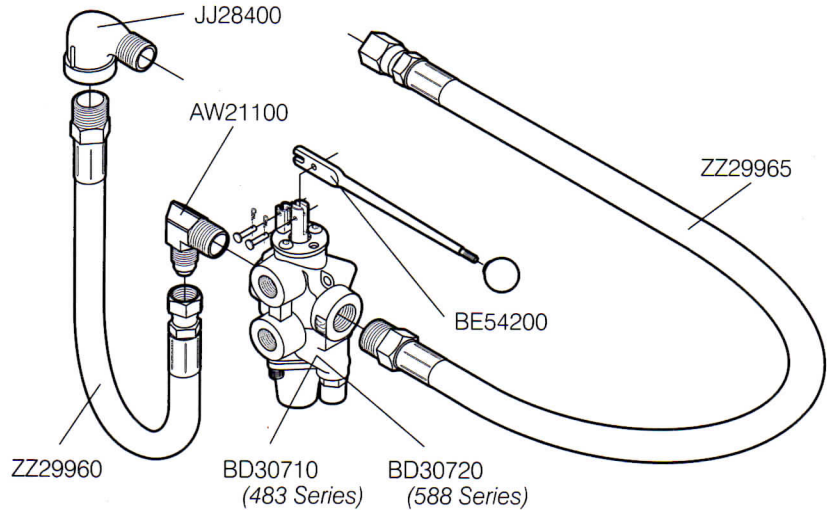

Hydraulic Pump, Filter and Mount

Part No.	Description
JJ20040	Pipe Nipple
LE14800	Oil Filter Housing (Note direction of Arrow when installing)
LE51100	Oil Filter Element (Equivalent to NAPA No. 1552, FRAM P1654A, and others)
ZZ29971	Suction Hose
AW21080	90° Elbow (<i>Pump Outlet</i>)
WC17800	Hydraulic Pump (483 Series)
WC18700	Hydraulic Pump (588 Series)
AW21170	90° Elbow (<i>Pump Inlet</i>)
BU46655	Adapter Ring
MR81950	Coupler, Pump Shaft
MR82500	Coupler, Engine Shaft
MR60800	Rubber Coupling Spider
BU16450	Pump Mount
BV80050	Access Cover

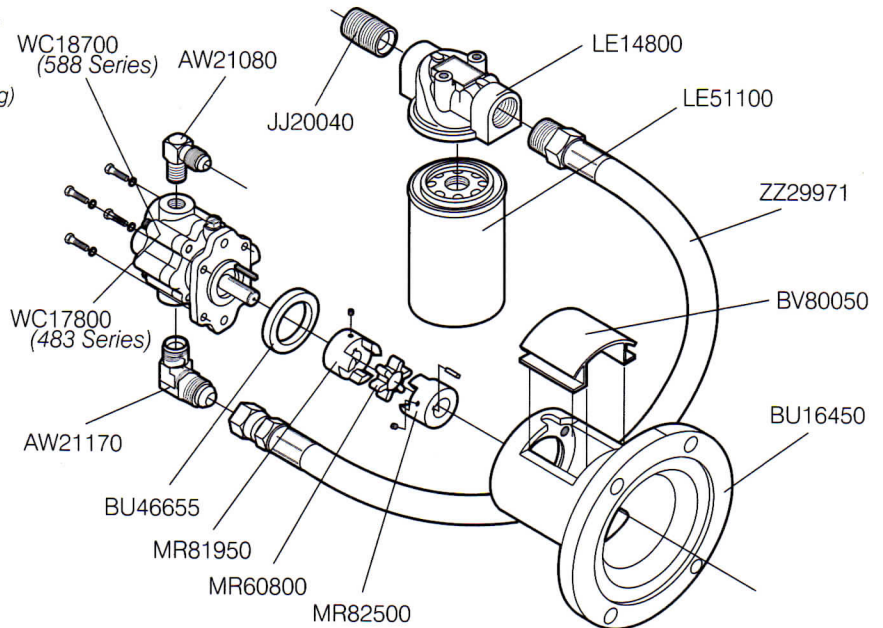

Tank and Frame

Part No.	Description
BW20000	Tank & Frame Assembly (<i>Unpainted</i>)
SS05610	Filler Cap/Breather Assembly
ZZ45140	Control Valve Mounting Nuts (<i>Three required</i>)

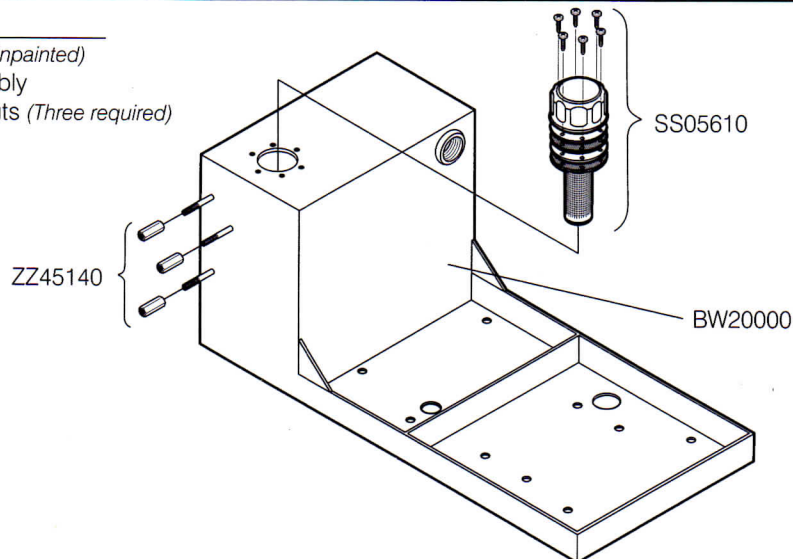

419-832-2822
1-800-824-1739

Fax 419-832-0255
www.buckeyehydraulics.com



Limited Warranty

1. We warrant each "Auger-Mate®" we sell to be free from manufacturing defects in normal service for a period of ninety (90) days from receipt of Product Registration Card at BUCKEYE HYDRAULICS, INC.
2. Our obligation under this warranty is expressly limited to replacement, or repair, at BUCKEYE HYDRAULICS, INC., Grand Rapids, Ohio, or at another point designated by us; or such part or parts as shall appear to us to have been defective. We shall not be liable for consequential labor costs or transportation charges in connection with the replacement or repair of any defective parts. This warranty does not apply to failures caused by:
 - Running the unit low on oil
 - Failure to keep the unit clean or running contaminated oil
 - Lack of proper maintenance
 - Use of incorrect oil
 - Abuse or using the unit for other than the intended purpose
 - Overtightening of fittings
 - Improper system plumbing
 - Normal wear
 - Deliberate engine overspeeding
 - Modifications to the unit
3. We shall not be liable for consequential damages or contingent liabilities, nor for the fitness of the "Auger-Mate" for any particular purpose.
4. We make no express, implied, or statutory warranty, nor is anyone authorized to make any on our behalf.
5. The above warranty applies to direct sales only. Any Dealer or Distributor must take care of their own warranties, with the exception of parts, which we will credit if found defective. This warranty does not apply to an "Auger-Mate" which has been repaired or altered by others without the written permission of BUCKEYE HYDRAULICS, INC.

Engine service problems and warranty issues must be handled through the appropriate engine dealer.

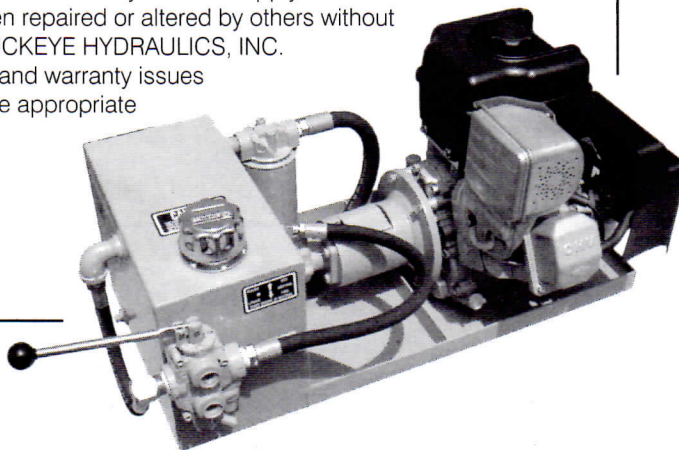

P.O. Box 500 24247 W. Third Street Grand Rapids, Ohio 43522
419-832-2822 1-800-824-1739
Fax 419-832-0255 www.buckeyehydraulics.com